

Soils Map

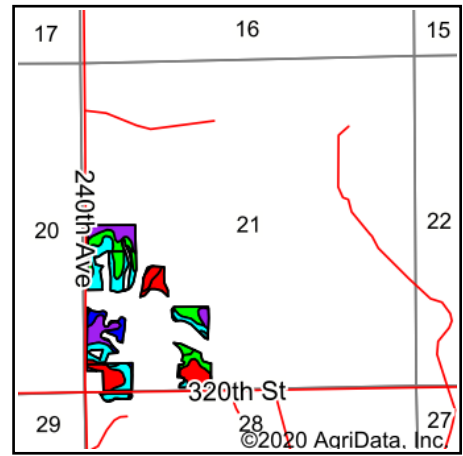

State: **Iowa**
 County: **Keokuk**
 Location: **21-74N-11W**
 Township: **Jackson**
 Acres: **41.32**
 Date: **11/18/2020**

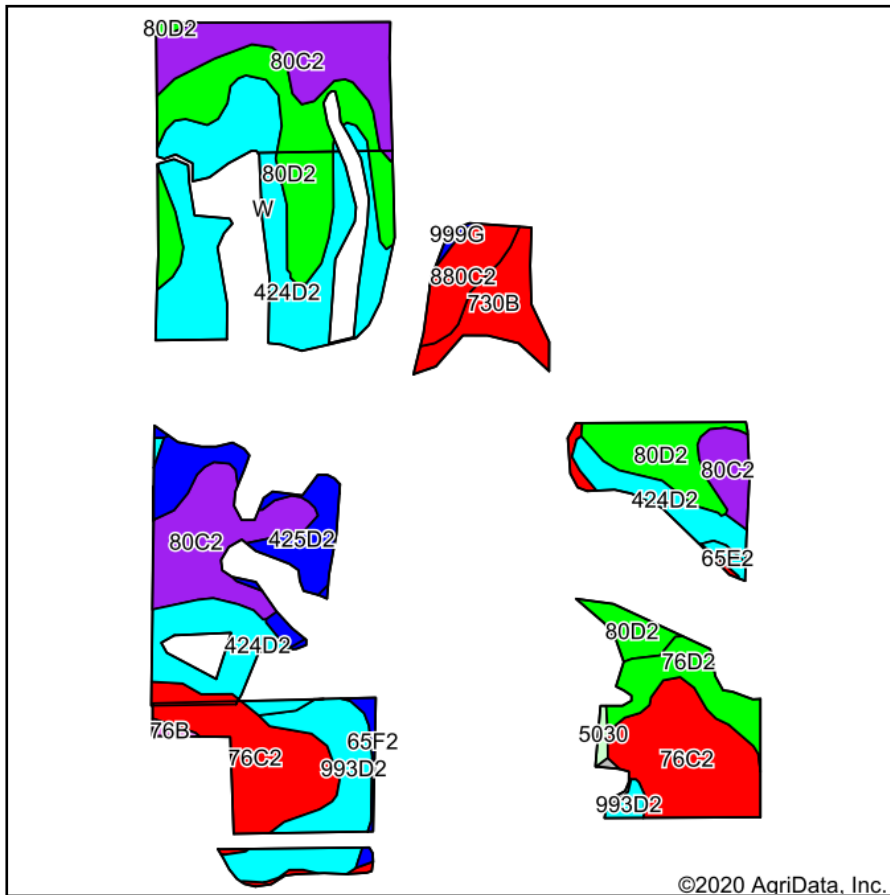

Soils data provided by USDA and NRCS.

Area Symbol: IA107, Soil Area Version: 25								
Code	Soil Description	Acres	Percent of field	CSR2 Legend	Non-Irr Class *c	CSR2**	CSR	*n NCCPI Soybeans
424D2	Lindley-Keswick complex, 9 to 14 percent slopes, moderately eroded	9.84	23.8%		IVe	25	15	49
80D2	Clinton silty clay loam, 9 to 14 percent slopes, eroded	7.12	17.2%		IIIe	46	50	59
80C2	Clinton silty clay loam, 5 to 9 percent slopes, eroded	6.93	16.8%		IIIe	69	60	62
76C2	Ladoga silty clay loam, 5 to 9 percent slopes, eroded	6.75	16.3%		IIIe	75	65	66
993D2	Gara-Armstrong complex, 9 to 14 percent slopes, moderately eroded	2.86	6.9%		IVe	30	20	49
425D2	Keswick clay loam, 9 to 14 percent slopes, moderately eroded	2.19	5.3%		IVe	9	12	41
730B	Nodaway occasionally flooded-Coppock-Cantril rarely flooded complex, 2 to 5 percent slopes	1.96	4.7%		IIw	76	61	80
76D2	Ladoga silty clay loam, 9 to 14 percent slopes, eroded	1.55	3.8%		IIIe	49	55	61
880C2	Clinton silty clay loam, terrace, 5 to 9 percent slopes, eroded	1.28	3.1%		IIIe	71	60	63
65F2	Lindley loam, 18 to 25 percent slopes, moderately eroded	0.29	0.7%		VIIe	10	8	39
65E2	Lindley loam, 14 to 18 percent slopes, moderately eroded	0.16	0.4%		VIe	27	28	53
5030	Pits, limestone quarry	0.13	0.3%			0	0	
76B	Ladoga silt loam, 2 to 5 percent slopes	0.11	0.3%		Ile	86	85	79
999G	Nordness-Eleva complex, 25 to 40 percent slopes	0.09	0.2%		VIIIs	5	5	4
179E2	Gara clay loam, 14 to 18 percent slopes, moderately eroded	0.06	0.1%		VIe	33	33	53
Weighted Average						48.4	42.2	*n 57.4

**IA has updated the CSR values for each county to CSR2.
 *n: The aggregation method is "Weighted Average using all components"
 *c: Using Capabilities Class Dominant Condition Aggregation Method
 Soils data provided by USDA and NRCS.