

Soils Map

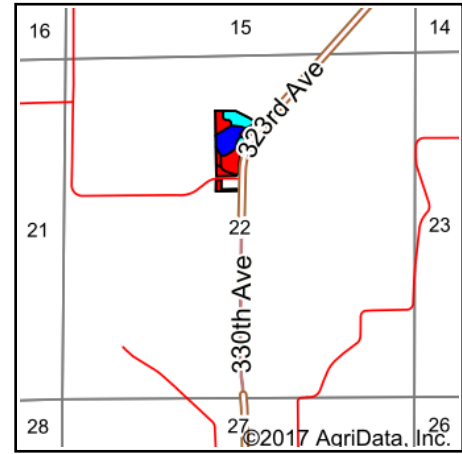

State: **Iowa**
 County: **Keokuk**
 Location: **22-74N-10W**
 Township: **Richland**
 Acres: **10.7**
 Date: **11/6/2017**

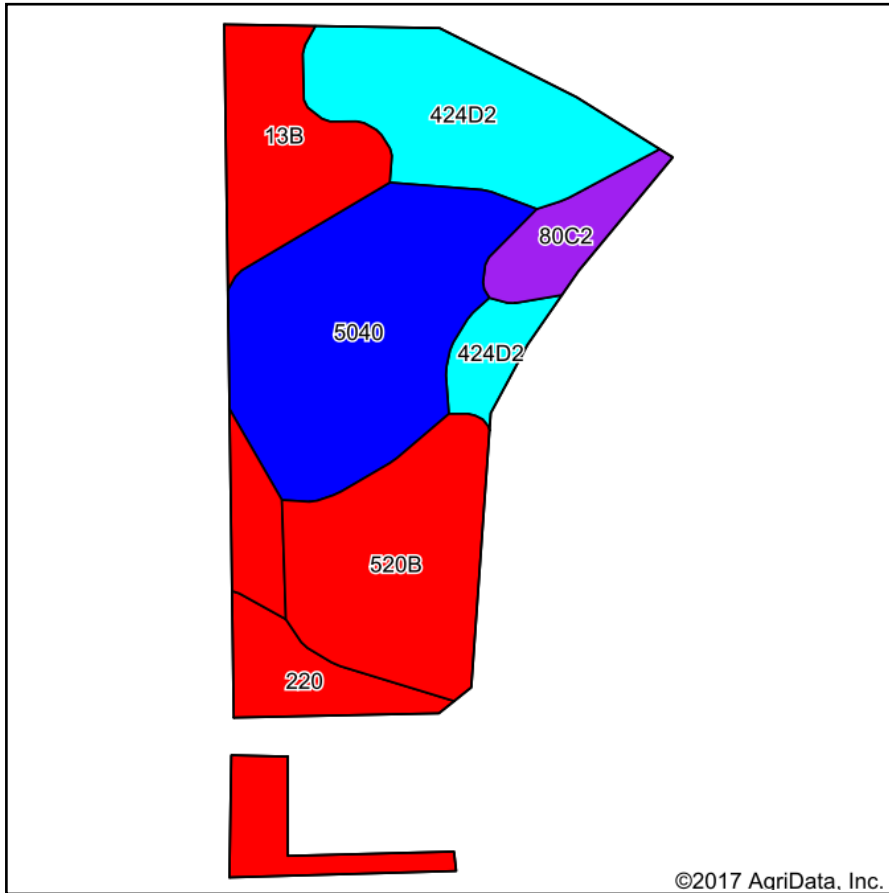





GREINER
 REAL ESTATE & AUCTION LLC
 (319) 694-4522

Maps Provided By:

 CUSTOMIZED ONLINE MAPPING
 © AgriData, Inc. 2017 www.AgriDataInc.com



Area Symbol: IA107, Soil Area Version: 21

Code	Soil Description	Acres	Percent of field	CSR2 Legend	Non-Irr Class *c	CSR2**	CSR
5040	Orthents, loamy	3.01	28.1%			5	5
424D2	Lindley-Keswick complex, 9 to 14 percent slopes, moderately eroded	2.27	21.2%		IVe	25	15
520B	Coppock silt loam, 2 to 5 percent slopes, rarely flooded	2.06	19.3%		IIw	80	60
13B	Olmitz-Vesser-Zook complex, 0 to 5 percent slopes	1.64	15.3%		IIw	76	60
220	Nodaway silt loam, shallow loess, 0 to 2 percent slopes, occasionally flooded	1.15	10.7%		IIw	77	87
80C2	Clinton silty clay loam, 5 to 9 percent slopes, eroded	0.57	5.3%		IIIe	69	60
Weighted Average						45.7	37.9

**IA has updated the CSR values for each county to CSR2.

*c: Using Capabilities Class Dominant Condition Aggregation Method

Soils data provided by USDA and NRCS.